

## 10-35 kVA High Ambient Vision Range

The Gentec fully weatherproof sound attenuated (SA) enclosures reduce sound levels to comply with the new European Community regulations 2000/14/EC which became effective on 1 January 2002.

They provides the benefit of increased ease of installation and serviceability, all within a compact footprint.



### Modular Acoustic Enclosure

#### Highly Corrosion Resistant Construction

- Black zinc die cast hinges tested and proven to withstand extremely corrosive conditions
- Zinc passivated and stainless steel fasteners
- Body made from sheet steel components with polyester powder coating at 200°C (392°F)

#### Excellent Access for Maintenance

- Vertically hinged side doors allowing 180° opening rotation
- Front and rear “lift-off” access panels
- Radiator fill access through cover in canopy roof
- Lube oil drain and radiator drain

#### Security and Safety

- Perspex control panel viewing window in a lockable access door
- Emergency stop button mounted on canopy exterior
- Cooling fan and battery charging alternator fully guarded
- Fuel fill and battery can only be reached via lockable access doors
- Exhaust silencing system enclosed for operator safety

#### Transportability

- Lifting points on baseframe

## SOUND PRESSURE LEVELS (dBA)

Generating Set Model	50 Hz at 1500/3000 RPM								60 Hz at 1800/3600 RPM						
	rpm	LWA	15 m (50 ft)		7 m (23 ft)		1 m (3 ft)		rpm	15 m (50 ft)		7 m (23 ft)		1 m (3 ft)	
			75% Load	100% Load	75% Load	100% Load	75% Load	100% Load		75% Load	100% Load	75% Load	100% Load	75% Load	100% Load
PI2.5P2	1500	87	54.3	56.6	60.3	62.6	71.3	73.4	1800	59.7	59.8	65.8	65.8	77.2	77.1
PI3.5E2	1500	87	54.3	55.9	60.3	61.9	71.3	73.8	1800	59.7	59.8	65.8	65.8	77.2	77.1
PI6.5P2	1500	88	57.3	57.3	63.3	63.3	75.4	75.4	1800	60.1	60.1	66.1	66.1	76.1	76.1
PI8E2	1500	88	57.3	57.3	63.3	63.3	75.4	75.4	1800	60.1	60.9	66.1	66.9	76.1	77.7
P20P2	1500	89	58.7	60.4	64.7	66.4	74.8	75.7	1800	60.1	60.9	66.1	66.9	76.1	77.7
P22E2	1500	89	58.7	59.2	64.7	65.2	74.8	76.0	1800	60.1	62.7	66.1	68.7	76.1	78.8
PH22E2	3000	96	66.9	66.8	72.9	72.8	83.5	83.5	3600	67.2	68.3	74.3	75.3	85.7	86.6
PH30E2	3000	98	65.9	65.8	71.9	71.8	83.5	83.4	n/a	n/a	n/a	n/a	n/a	n/a	n/a
PH35E2	3000	98	67.1	67.4	73.1	73.4	83.3	84.1	n/a	n/a	n/a	n/a	n/a	n/a	n/a
PI0P2S	1500	87	54.3	56.6	60.3	62.6	71.3	73.4	1800	59.7	59.8	65.8	65.8	77.2	77.1
PI1E2S	1500	87	54.3	55.9	60.3	61.9	71.3	73.8	1800	59.7	59.8	65.8	65.8	77.2	77.1
PI3P2S	1500	88	57.3	57.3	63.3	63.3	75.4	75.4	1800	60.1	60.1	66.1	66.1	76.1	76.1
PI4E2S	1500	88	57.3	57.3	63.3	63.3	75.4	75.4	1800	60.1	60.9	66.1	66.9	76.1	77.7
PI5P2S	1500	89	58.7	60.4	64.7	66.4	74.8	75.7	1800	60.1	60.9	66.1	66.9	76.1	77.7
PI6.5E2S	1500	89	58.7	59.2	64.7	65.2	74.8	76	1800	60.1	62.7	66.1	68.7	76.1	78.8
PH17E2S	3000	96	66.9	66.8	72.9	72.8	83.5	83.5	3600	67.2	68.3	74.3	75.3	85.7	86.6
PH24E2S	3000	98	65.9	65.8	71.9	71.8	83.5	83.4	n/a	n/a	n/a	n/a	n/a	n/a	n/a
PH28E2S	3000	98	67.1	67.4	73.1	73.4	83.3	84.1	n/a	n/a	n/a	n/a	n/a	n/a	n/a

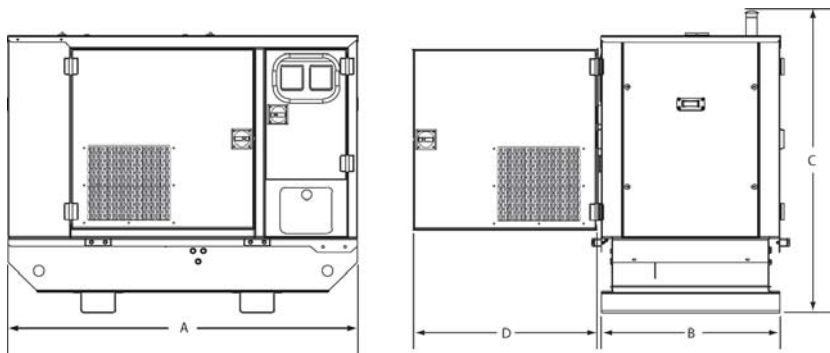

## DIMENSIONS AND WEIGHTS

Generating Set Model	A mm (in)	B mm (in)	C mm (in)	D mm (in)	E mm (in)	Weight Kg(lb)	Fuel Capacity L (US Gal)
PI2.5P2/PI3.5E2	1684 (66.3)	860 (33.9)	1252 (49.3)	1382 (54.4)	880 (34.6)†	654 (1442)	45.0 (12.0)
PI6.5P2/PI8E2	1684 (66.3)	860 (33.9)	1252 (49.3)	1382 (54.4)	880 (34.6)†	715 (1576)	45.0 (12.0)
P20P2/P22E2	1684 (66.3)	860 (33.9)	1252 (49.3)	1382 (54.4)	880 (34.6)†	728 (1605)	45.0 (12.0)
PH22E2	1684 (66.3)	860 (33.9)	1252 (49.3)	1382 (54.4)	880 (34.6)†	632 (1393)	45.0 (12.0)
PH30E2	1684 (66.3)	860 (33.9)	1252 (49.3)	1382 (54.4)	880 (34.6)†	698 (1539)	45.0 (12.0)
PH35E2	1684 (66.3)	860 (33.9)	1252 (49.3)	1382 (54.4)	880 (34.6)†	720 (1587)	45.0 (12.0)
PI0P2S/PI1E2S	1684 (66.3)	860 (33.9)	1252 (49.3)	1382 (54.4)	880 (34.6)†	654 (1442)	45.0 (12.0)
PI3P2S/PI4E2S	1684 (66.3)	860 (33.9)	1252 (49.3)	1382 (54.4)	880 (34.6)†	715 (1576)	45.0 (12.0)
PI5P2S/PI6.5E2S	1684 (66.3)	860 (33.9)	1252 (49.3)	1382 (54.4)	880 (34.6)†	728 (1605)	45.0 (12.0)
PH17.5E2S	1684 (66.3)	860 (33.9)	1252 (49.3)	1382 (54.4)	880 (34.6)†	632 (1393)	45.0 (12.0)
PH24E2S	1684 (66.3)	860 (33.9)	1252 (49.3)	1382 (54.4)	880 (34.6)†	698 (1539)	45.0 (12.0)
PH28E2S	1684 (66.3)	860 (33.9)	1252 (49.3)	1382 (54.4)	880 (34.6)†	720 (1587)	45.0 (12.0)

Note: Net Weight with lube oil, no coolant, no fuel.  
 † Clearance required both sides.

